

REV.	SPECIFICATION	ECN NO.	APPD.
X2			

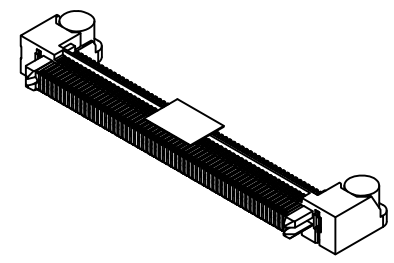

Material:
Housing: LCP, UL94V-0, Black.
Contacts: Phosphor Bronze, Gold Plated on Contact Area and Matte Tin Plated on Solder Tail over Nickel 50 u" Min.
Counterweight: Brass
Latches: Brass

Electrical Characteristics:
Current Rating: 1.4 AMP.
Dielectric Withstanding Voltage: AC 900V.
Insulation Resistance: 50000MΩ min.
Contact Resistance: Δ15mΩ max.
Operating Temperature: -55°C~+125°C.
***RoHS Compliant**

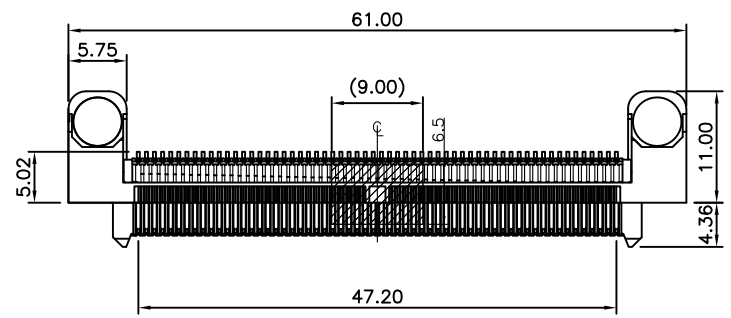
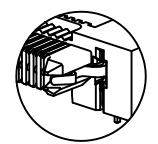
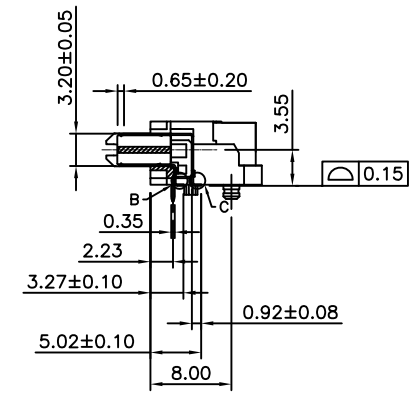
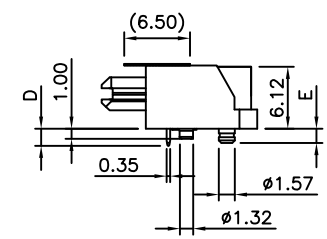
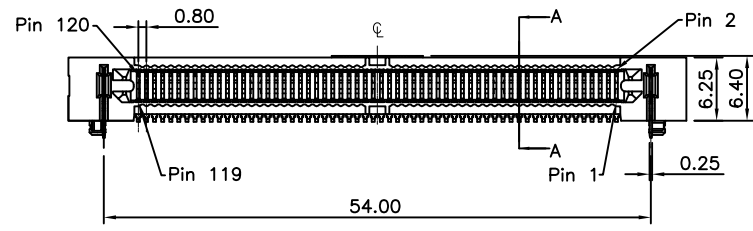

Type1 lock

Section A-A

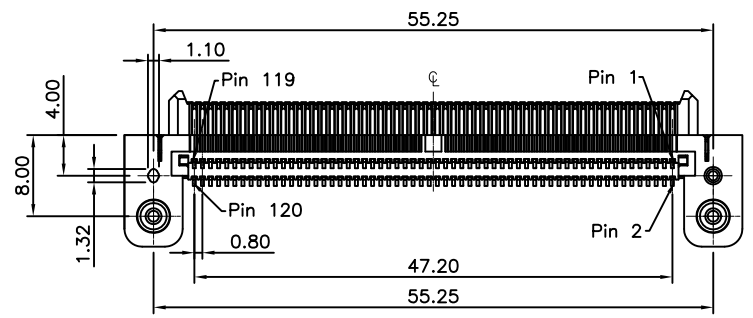

Series 2386- 1 2 X 60 C 3 D 1 X M L T - S
1: Male Right Angle
Double Row
Position Per Row
C: Selective Gold Plated
D: SMD Type
Code1-2

S: Mylar
Blank: W/O Mylar
T: Tape&Reel Package
L: Type lock
L1: Type1 lock
M: Metal Post
Blank: W/O Metal Post
Blank: Signal Pin 0.65mm
Ground Pin 0.65mm
A: Signal Pin 1.35mm
Ground Pin 0.65mm

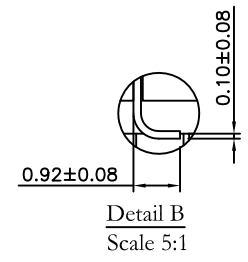

Detail B
Scale 5:1

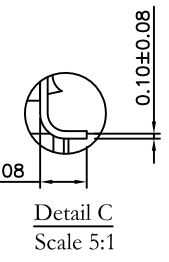

Detail C
Scale 5:1

PCB Thickness	Code	Lock	Metal Post
Dimension		D	E
1.58	1	1.68	1.40
2.36	2	2.46	2.19

Tolerances	Dwg No.	2386-D0000-003	Title:	
x = ±0.50	Projection		2386 Series	
.x = ±0.25	Unit	mm	Scale	1:1
.xx = ±0.15	Drawn By	CXP 07/25'18	Male Right Angle	

OUPIN			
OUPIN ELECTRONIC(KUNSHAN) CO., LTD.			
P/N: 2386-12X60C3D1xMLT-S			
SHEET	1/2	Ver.No.	X2

REV.	SPECIFICATION	ECN NO.	APPD.
X2	NEW		

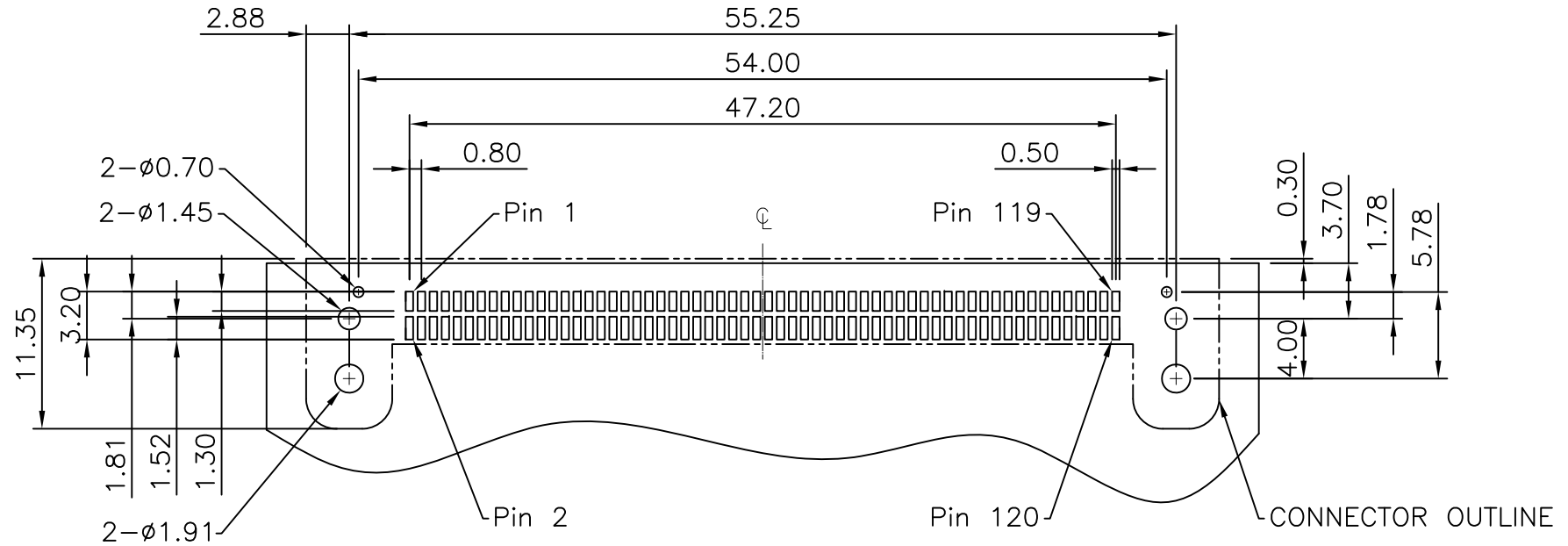

Recommended PCB Layout

Tolerances	Dwg No.	2386-D0000-003
x = ±0.50	Projection	
.x = ±0.25	Unit	mm
.xx = ±0.15	Scale	1:1
	Drawn By	CXP 07/25'18

Title:
2386 Series
Male Right Angle

OUPIN			
OUPIN ELECTRONIC(KUNSHAN) CO., LTD.			
P/N: 2386-12X60C3D1xMLT-S			
SHEET	2/2	Ver.No.	X2